

APS1 Module

Installation Instructions

The Automax APS1 may be installed very easily to the SuperNova series spring return actuators utilizing any Automax A25N series NAMUR solenoid valve.

1. Place each O-ring provided into the O-ring bore on the rear of the module (the side with two large ports). Each O-ring should be completely seated in the bore.
2. Place the actuator with the two ports facing you, and the stem pointing up. Orient the APS1 module with the O-rings toward the actuator, and the central thru-port hole to the right.
3. Place the Automax solenoid valve with the (3) O-rings toward the APS1 and the operator toward the right.
4. The APS1 is then "sandwich" mounted between the solenoid valve and the SuperNova actuator with the two screws provided.
5. Install the pipe plug into port #3 of the solenoid valve and the bronze breather vent into port #5.
6. Connect the air supply to port #1 and the assembly is ready for operation.

Operation

The Automax APS1 with the Automax A25N solenoid valve purges the spring chamber with exhaust air. This prevents corrosive atmospheres from being pulled into the spring chamber.

The APS1 consists of a single compact block with no moving parts, sandwich mounted between the SuperNova actuator and the Automax solenoid valve. There are no tubing or fittings required.

Maintenance Instructions

Trouble Shooting the APS1

Actuator will not cycle.

1. Check for proper orientation of APS1 and solenoid valve.
2. Check for plugged exhaust port.
3. Check for correct supply pressure.

Air leaks through breather exhaust when actuator is held open.

1. Check for actuator leakage.
2. Check for solenoid valve leakage.

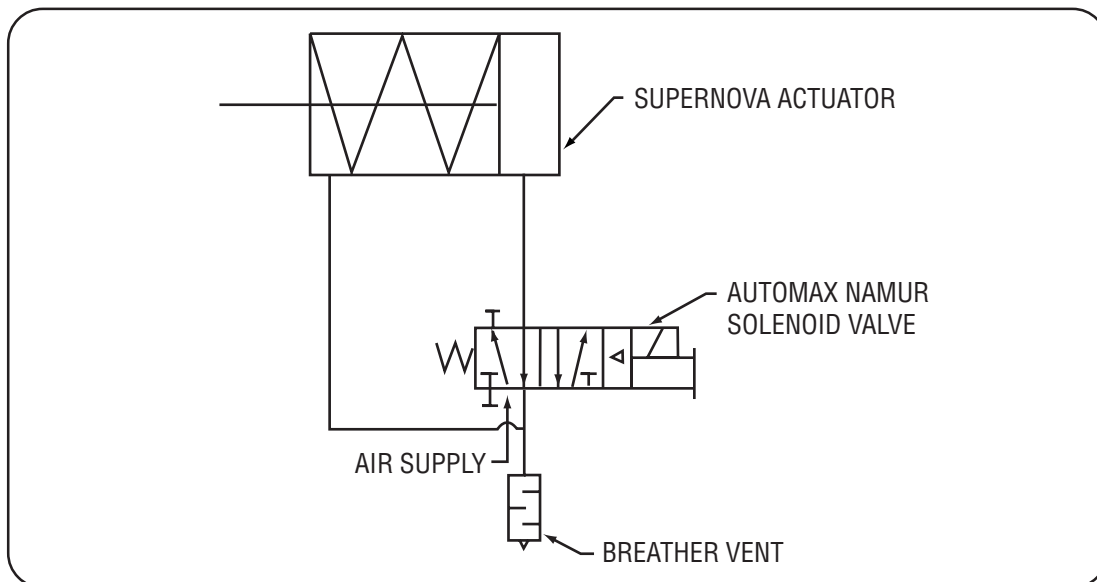

APS1 Profile View

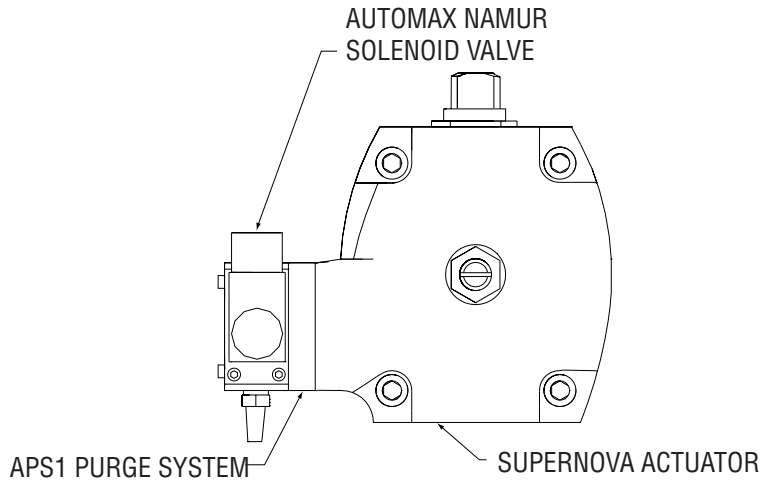

APS1 Exploded View with BOM

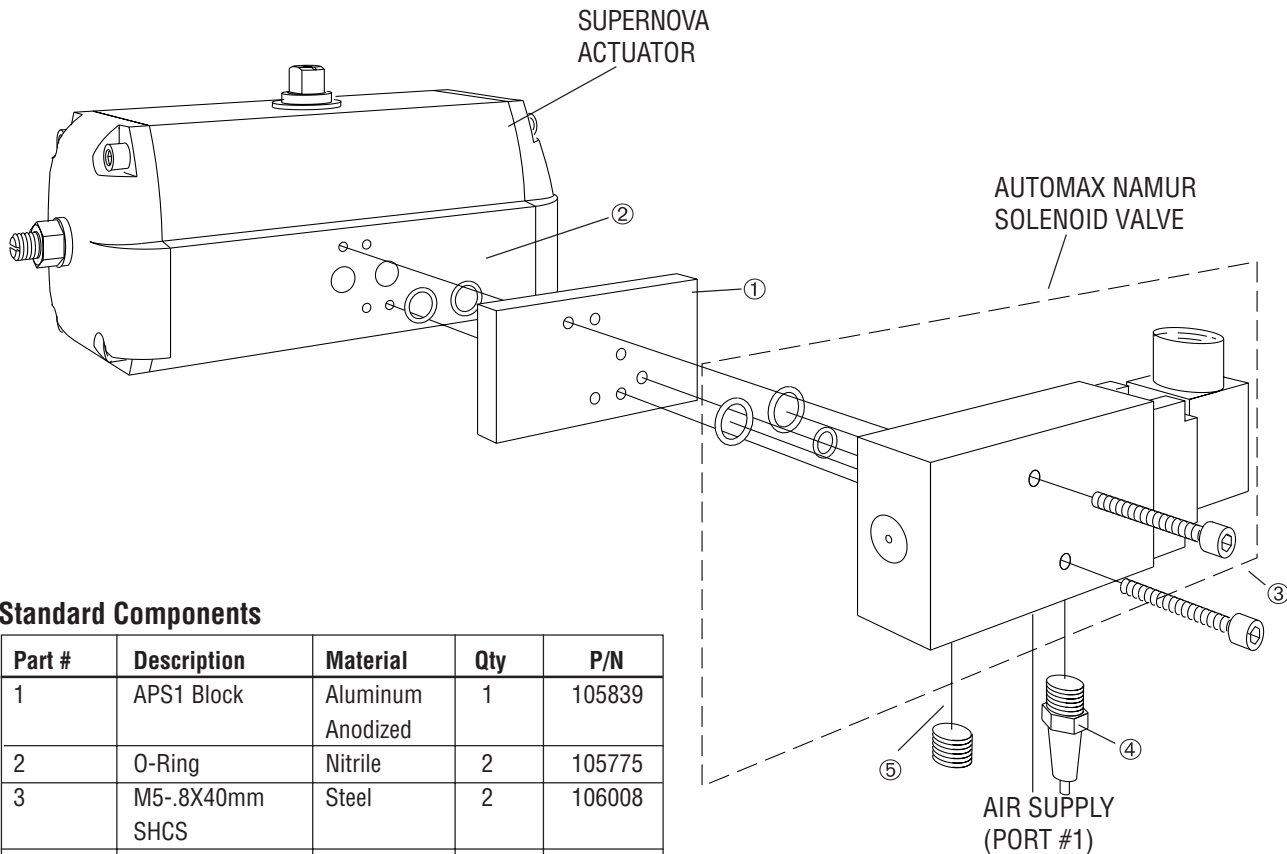

Standard Components

Part #	Description	Material	Qty	P/N
1	APS1 Block	Aluminum Anodized	1	105839
2	O-Ring	Nitrile	2	105775
3	M5-.8X40mm SHCS	Steel	2	106008
4	Vent	Bronze	1	106200
5	Pipe Plug	Steel	1	100933