

# Chemiepac Mechanical Seal for Corrosive Duties

Today, there are many corrosive mediums being pumped in chemical and pharmaceutical industries, metal and similar processes. For these types of services, pumps are lined internally with plastics, rubber or ceramic. The Chemiepac with PTFE bellows meets the sealing needs of these services.

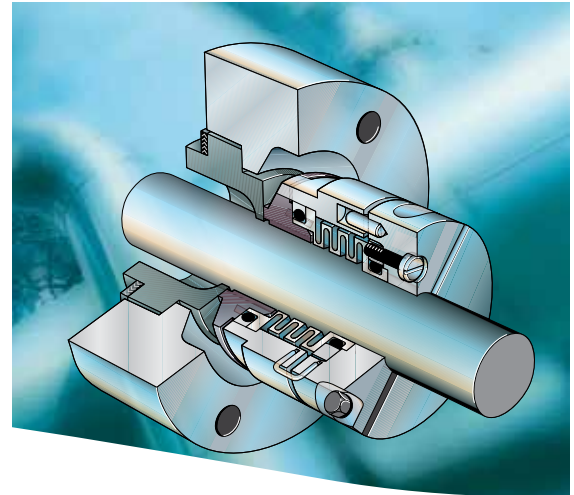

## Standard Operating Parameters

Chemiepac	955	970
Shaft sizes:	18 - 100 mm	18 - 100 mm
Surface speed:	8 m/sec.	8 m/sec.
Temperature:	up to 100 °C	up to 125 °C
Pressure :	2 - 11 bar	2 - 13.5 bar

The pressure load is dependent upon the shaft size and the temperature.

## Standard Materials of Construction

Chemiepac	955	970
<b>Medium</b>	<b>corrosive</b>	<b>corrosive and containing light solid particles</b>
Rotating face:	PTFE	Silicon Carbide (replaceable)
Stationary face:	Al-Oxide	Silicon Carbide
Bellows:	PTFE	PTFE
Springs :	Alloy C	Alloy C
Spring plate:	PTFE	PTFE
Retainer:	316 TI Stainless Steel or Alloy C	316 TI Stainless Steel or Alloy C

## Features / Benefits

- Externally mounted single mechanical seal - no flange required
- PTFE bellows with integral sintered or separate rotating face
- Anti-slip attachment of the PTFE bellows to the pump shaft - no additional support ring required
- Metal-free components on the product side - corrosion resistance
- Installation mechanism - the Chemiepac is adapted to seal chamber dimensions
- Stationary face with adequate clearance around the shaft - eliminates clogging, good heat transfer
- Multiple spring design

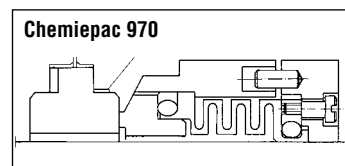
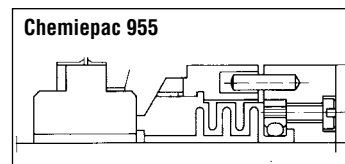

Chemiepac 970 with replaceable rotating face for mediums containing light solid particles and/or crystallizing mediums

## Dimensional Data

### Chemiepac 955

p max. (bar) at t =

D1	D2	D3	D6	D7	L1	L2	L3	L4	L5	25°C	50°C	100°C
18	21	47	36.50	46	40	018	5	8	1	11	8.5	5.5
24	27	58	42.85	53	44	18	5	8	1	11	8.5	5.5
28	32	63	50.80	64	44	27	8	11	2	11	8.5	5.5
33	37	68	57.15	70	44	27	8	11	2	10	8	5
35	37	68	57.15	70	44	27	8	11	2	10	8	5
43	48	85	69.85	83	53	27	8	11	2	9	7	4
53	57.4	95	82.55	99	53	33.3	9.5	14.3	2	8	5.5	3.5
58	61	109	85.70	102	65	33.3	9.5	14.3	2	7	5	3
65	71	119	95.25	112	65	33.3	9.5	14.3	2	7	5	3
95	98.2	147	123.80	140	70	33.3	9.5	14.3	2	5	3.5	2
100	105	156	130.15	146	82	33.3	9.5	14.3	2	5	3.5	2

Chemiepac 955

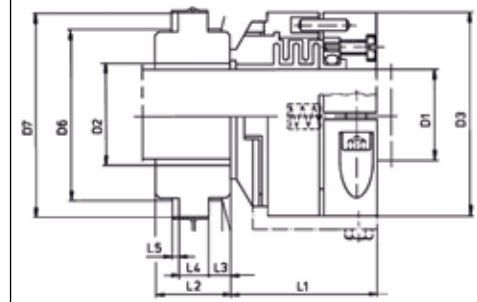

### Chemiepac 970

p max. (bar) at t =

D1	D2	D3	D6	D7	L1	L2	L3	L4	L5	25°C	50°C	100°C	125°C
18	21	47	36.50	46	45.5	18	5	8	1	13.5	11.5	6.5	4.5
24	27	58	42.85	53	49	18	5	8	1	13.5	11.5	6.5	4.5
28	32	63	50.80	64	49	27	8	11	2	13.5	11.5	6.5	4.5
33	37	68	57.15	70	49	27	8	11	2	13.5	11.5	6.5	4.5
35	37	68	57.15	70	49	27	8	11	2	13.5	11.5	6.5	4.5
43	48	85	69.85	83	62	27	8	11	2	12.5	10	5.5	3
53	57.4	95	82.55	99	62	33.3	9.5	14.3	2	11.5	9.5	4.5	3
58	61	109	85.70	102	72	33.3	9.5	14.3	2	10.5	8	4	2.5
65	71	119	95.25	112	72	33.3	9.5	14.3	2	10.5	8	4	2.5
95	98.2	147	123.80	140	74.5	33.3	9.5	14.3	2	6.5	5	2.5	2
100	105	156	130.15	146	89.5	33.5	9.5	14.3	2	6.5	5	2.5	2

Chemiepac 970

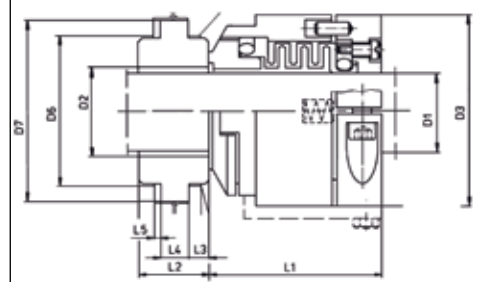

Dimensions for other shaft sizes or L1 or inch measures on request

FSD126eng REV 01-06 Printed in Europe

**To find your local Flowserve representative**  
and find out more about Flowserve Corporation visit  
[www.flowserve.com](http://www.flowserve.com)

**ISO 9000**  
Certified

Flowserve Corporation has established industry leadership in the design and manufacture of its products. When properly selected, this Flowserve product is designed to perform its intended function safely during its useful life. However, the purchaser or user of Flowserve products should be aware that Flowserve products might be used in numerous applications under a wide variety of industrial service conditions. Although Flowserve can provide general guidelines, it cannot provide specific data and warnings for all possible applications. The purchaser/user must therefore assume the ultimate responsibility for the proper sizing and selection, installation, operation, and maintenance of Flowserve products. The purchaser/user should read and understand the Installation Instructions included with the product, and train its employees and contractors in the safe use of Flowserve products in connection with the specific application.

While the information and specifications contained in this literature are believed to be accurate, they are supplied for informative purposes only and should not be considered certified or as a guarantee of satisfactory results by reliance thereon. Nothing contained herein is to be construed as a warranty or guarantee, express or implied, regarding any matter with respect to this product. Because Flowserve is continually improving and upgrading its product design, the specifications, dimensions and information contained herein are subject to change without notice. Should any question arise concerning these provisions, the purchaser/user should contact Flowserve Corporation at any one of its worldwide operations or offices.

© 2005 Flowserve Corporation

#### USA and Canada

Kalamazoo, Michigan USA  
Telephone: +1 269 381 2650  
Telefax: +1 269 382 8726

#### Europe, Middle East, Africa

Essen, Germany  
Telephone: +49 201 39 370  
Telefax: +49 201 2200 561

#### Asia Pacific

Singapore  
Telephone: +65 6544-6800  
Telefax: +65 6214-0541

#### Latin America

Mexico City  
Telephone: +52 55 5567 7170  
Telefax: +52 55 5567 4224